

Delta UPS Agilon Family

VX Series, Line-interactive
600-1500 VA

Installation & Operation Quick Guide

ENGLISH

1 Package Inspection

No.	Item	Q'ty
1	UPS	1 PC
2	Quick Guide	1 PC
3	Output Power Cord (10A)	2 PCS
4	USB Cable	1 PC
5	AC Power Cord	1 PC

Remove the UPS from its package and inspect it for damage that may have occurred during shipping. If any damage is discovered, re-pack the unit and return it to the place of purchase.

2 Front Panel & Rear Panel

• 600VA

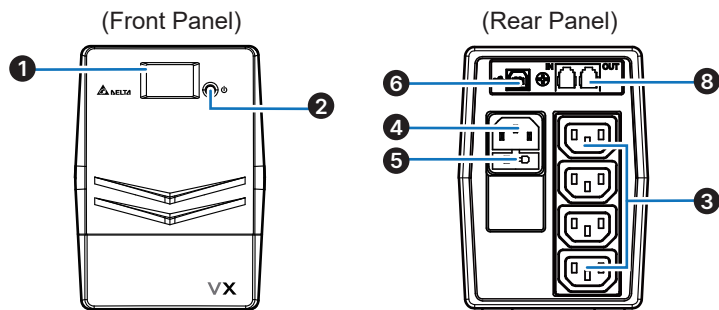

• 1000VA

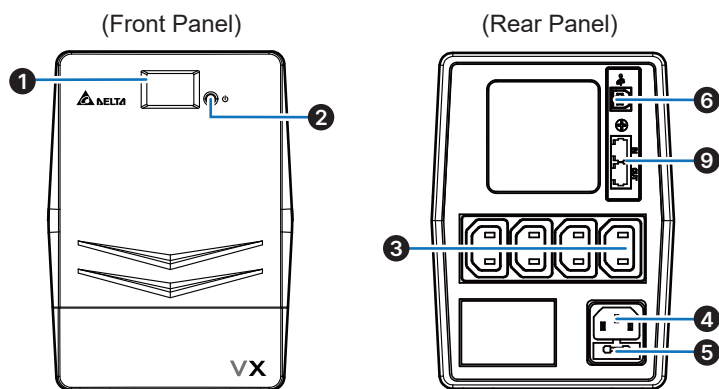

• 1500VA

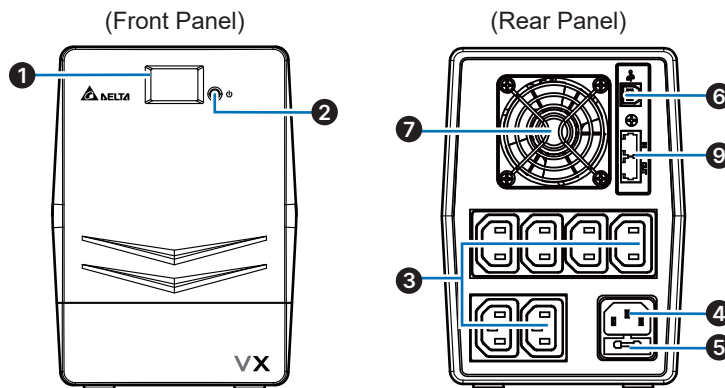

No.	Item
1	LCD Touch Panel
2	ON/ OFF Button
3	Output Socket
4	AC Input
5	Fuse
6	USB Port
7	Cooling Fan (Only For 1500VA Model)
8	Modem/ Phone Surge Protection Port
9	Modem/ Phone/ Network Surge Protection Port

3 Operation

• Placement

Install the UPS in a protected area that is free of excessive dust and has adequate air flow. Place the UPS away from other units at least 20cm to avoid interference. For best performance, keep the indoor temperature between 0°C and 40°C.

• Connect to Utility Power

Connect the AC power cord to the utility power. Then, the UPS will start to charge its inside battery (batteries). For best result, charge the battery (batteries) for 6 hours prior to initial use. It is not recommended to connect the UPS's AC power cord to any generator.

• Plug in Equipment

Plug your equipment to the Output Socket on the rear panel of the UPS.



NOTE:

Make sure that the UPS is powered on to protect all important devices from data loss during power failure.



WARNING:

NEVER connect a laser printer or scanner to the Output Socket of the UPS. The equipment may draw significant power to overload the UPS.

• Connect to USB Port and Install Software

Connect one end of the supplied USB cable to your PC and the other to the USB port located at the rear of the UPS. Download the latest version of ViewPower software (<http://www.deltapowersolutions.com/en/mcis/600va-1500va-single-phase-ups-vx-series-software-download.php>) to your hard drive. Follow on-screen instructions to complete the software installation.

• Turn On/ Off the UPS

When the UPS is OFF, press the ON/ OFF Button to turn on the UPS and the LCD will be on. When the UPS is ON, press the ON/ OFF Button to turn off the UPS and the LCD will shut off.

• Fuse Replacement

When the UPS always runs in battery mode, it might be because the fuse is damaged. If yes, please follow the following procedures to replace the fuse.

1 Remove the fuse cover from the rear panel.

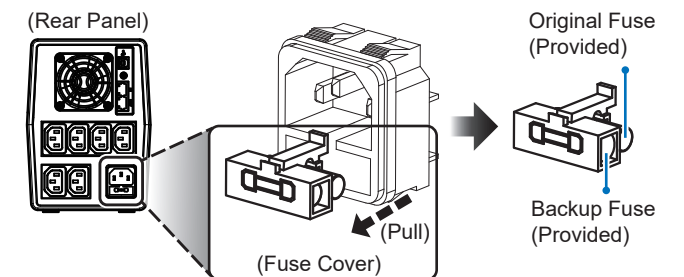

2 Replace the original fuse 1 with the provided backup fuse 2.

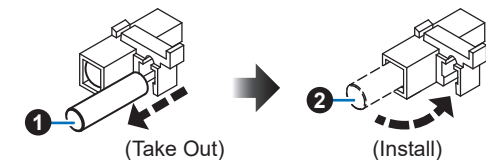

3 Replace the fuse cover back to the rear panel.

• Storage

All connected equipment should be turned off and disconnected from the UPS to avoid battery drain. Unplug the UPS from the wall outlet and turn off the UPS for storage. Store the UPS unit covered and upright in the environment where the ambient temperature is -20°C to 50°C with its battery fully charged.

4 LCD Display

• Operation Display:

UPS Mode	LCD Touch Panel	Description
UPS Power On		When the UPS is powered on, it will enter this mode for 4 seconds.
AC Mode	 When AVR is functioning, icon will flash every second.	LCD information will be displayed in the following order when the LCD is touched. 1. Output voltage 2. Input voltage 3. Load level 4. Battery capacity
Overload In AC Mode	 icon will flash.	When overload occurs, alarm will beep every 0.5 second.
Battery Mode	 When battery level is low, icon will flash.	Alarm will beep every 10 seconds and LCD information will be displayed in the following order when the LCD is touched. 1. Output voltage 2. Input voltage 3. Load level 4. Battery capacity
Overload In Battery Mode	 icon will flash.	When overload occurs, alarm will beep every 0.5 second.

NOTE:
If backlight shuts off, you can activate it by touching the screen.

• Fault Code Table:

Fault Condition	LCD Touch Panel	Solutions
Output Short Circuited		Disconnect short-circuited loads and restart the UPS again.
Overload Fault		Disconnect all output loads and restart the UPS again.
Over Charge Fault		Call for service immediately.
Battery Too Low Fault		Please replace the battery (batteries).
Battery Mode Output High Fault		Call for service immediately.
Over Temperature		1. Turn off the UPS and wait for cooling. 2. Or remove excessive loads and wait for cooling.

If any fault alarm occurs, please call for service immediately.

5 Safety Caution

SAVE THESE INSTRUCTIONS-This quick guide contains important instructions that should be followed during installation and maintenance of the UPS and battery (batteries).

- The UPS utilizes voltage that may be hazardous. Do not attempt to disassemble the unit. The unit contains no user replaceable parts. Only factory service personnel may perform repairs.
- This pluggable type A equipment with battery (batteries) already installed by the supplier is operator installable and may be operated by laymen.
- The mains socket outlet that supplies the UPS shall be installed near the UPS and shall be easily accessible.
- During the installation of this equipment it should be assured that the sum of the leakage current of the UPS and the connected loads does not exceed 3.5mA.
- Connection to any other type of receptacle other than a two-pole, three-wire grounded receptacle may result in shock hazard as well as violate local electrical codes.
- In the event of an emergency, press the ON/ OFF Button and disconnect the power cord from the AC power supply to properly disable the UPS.
- Do not allow any liquid or any foreign object to enter the UPS. Do not place beverages or any other liquid-containing vessels on or near the unit.
- The unit is intended for installation in a controlled environment (temperature controlled, indoor area free of conductive contaminants). Avoid installing the UPS in any location where there is standing or running water, or excessive humidity.
- Do not plug the UPS input into its own output.
- Do not attach a power strip or surge suppressor to the UPS.
- Do not attach non-computer-related items, such as medical equipment, life-support equipment, microwave ovens, or vacuum cleaners to the UPS.
- Do not dispose of battery (batteries) in a fire as they may explode.
- A battery can present a risk of electrical shock and high short circuit current. The following precautions should be observed when working on batteries:
 1. Remove watches, rings, or other metal objects from the hands.
 2. Use tools with insulated handles.
 3. Wear rubber gloves and boots.
 4. Do not lay tools or metal parts on top of battery (batteries).
 5. Disconnect charging source prior to connecting or disconnecting the terminals of battery (batteries).
- Internal battery voltage is 12Vdc. Battery type is sealed, lead-acid, 6-cell battery.

- Servicing of batteries should be performed or supervised by personnel knowledgeable of batteries and the required precautions. Keep unauthorized personnel away from batteries.
- When replacing battery (batteries), replace with the same number and type of sealed lead-acid battery (batteries).
- Do not open or mutilate the battery or batteries. Release electrolyte is harmful to the skin and eyes. It may be toxic.
- Attention! Hazardous through electric shock. Even disconnection of this unit from the mains, hazardous voltage still may be accessible through supply from the battery (batteries). The battery supply should be therefore disconnected in the plus and minus pole at the connectors of the battery (batteries) when maintenance or service work inside the UPS is necessary.
- To reduce the risk of overheating the UPS, do not cover the UPS's cooling vents and avoid exposing the unit to direct sunlight or installing the unit near heat emitting appliances such as heaters or furnaces.
- Unplug the UPS prior to cleaning and do not use liquid or spray detergent.

6 Troubleshooting

Problem	Possible Cause	Solutions
Nothing is displayed on the LCD panel.	The UPS is not on.	Press the ON/ OFF Button again to turn on the UPS.
	Battery voltage is too low.	Charge the battery (batteries) at least 6 hours.
	Battery fault.	Replace the battery (batteries).
The UPS always runs in battery mode.	The power cord becomes loose.	Re-plug the power cord.
	The fuse is damaged.	Replace the fuse. For how to replace the fuse, please refer to 3 Operation .
The UPS continuously beeps.	Please check the Fault Code Table for the details.	Please check the Fault Code Table for the details.
Backup time is too short.	Battery voltage is too low.	Charge the battery (batteries) at least 6 hours.
Backup time is too short.	Overload.	Remove some unnecessary loads. Before reconnecting equipment, please verify that the load matches the UPS capability specified in the specs.
	Battery defect.	Replace the battery (batteries).

If any abnormal situations occur that are not listed above, please call for service immediately.

7

Technical Specifications

Model	600VA	1000VA	1500VA
Capacity	600VA/360W	1kVA/600W	1.5kVA/900W
Nominal Input Voltage	230 Vac		
Input Voltage Range	170 ~ 280 Vac		
Output Voltage	230 Vac ± 10% (Bat. mode)		
Transfer Time	Typical 2 ~ 6 ms		
Waveform	Simulated Sine Wave		
Battery Type & No.	12V/7Ah × 1	12V/7Ah × 2	12V/9Ah × 2
Charging Time	Typical 6 ~ 8 hours		
Dimensions (D x W x H)	300 × 101 × 142 mm	320 × 130 × 182 mm	
Net Weight (kgs)	4.4	8.2	10.4
Humidity	0 - 90% RH @ 0 - 40°C (non-condensing)		
Noise Level	Less than 40dB		Less than 45dB

* Specifications are subject to change without notice.

8

Warranty

Seller warrants this product, if used in accordance with all applicable instructions, to be free from original defects in material and workman-ship within the warranty period. If the product has any failure problem within the warranty period, Seller will repair or replace the product at its sole discretion according to the failure situation.

This warranty does not apply to normal wear or to damage resulting from improper installation, operation, usage, maintenance or irre-sistible force (i.e. war, fire, natural disaster, etc.), and this warranty also expressly excludes all incidental and consequential damages. Maintenance service for a fee is provided for any damage out of the warranty period. If any maintenance is required, please directly contact the supplier or Seller.

!

WARNING:
The individual user should take care to determine prior to use whether the environment and the load characteristic are suitable, adequate or safe for the installation and the usage of this product. The Quick Guide must be carefully followed. Seller makes no representation or warranty as to the suitability or fitness of this product for any specific application.

Copyright © 2026 by Delta Electronics Inc. All rights reserved. Changes may be made periodically to the information in this Quick Guide without obligation to notify any person of such revision or changes.

Version Date : 2026_02_09

Global Headquarter

Taiwan
Delta Electronics Inc.
30 Section 2, Huandong Road, Shanhua District,
Tainan City 74144, Taiwan
T +886 6 505 6565
E ups.taiwan@deltaww.com

Regional Office

Netherlands
Delta Electronics (Netherlands) B.V.
Zandsteen 15, 2132 MZ Hoofddorp, The Netherlands
T +31 (0)20 800 3900
E info@delta-emea.com

Poland
Delta Electronics (Poland) Sp. z o.o.
23 Poleczki St., 02-822 Warszawa, Poland
T +48 22 335 26 00
E ups.poland@deltaww.com

Brazil
Delta Electronics Brasil Ltda.
Estrada Velha Rio-São Paulo, 5300 – Eugênio de Melo –
CEP 12247-001 São José dos Campos-SP-Brazil
T +55 12 39322300
E ups.brazil@deltaww.com

Peru
Delta Electronics (Peru) Inc. S.R.L.
Av. Pardo y Aliaga 699 Of. 601, San Isidro Lima, Peru.
T +51 962 834 287
E ups.peru@deltaww.com

China
Delta GreenTech (China) Co., Ltd.
238 Minxia Road, Pudong, Shanghai, 201209 P.R.C
T +86 21 5863 5678
+86 21 5863 9595
E ups.china@deltaww.com

South Korea
Delta Electronics (Korea), Inc.
1511, Byucksan Digital Valley 6-cha, Gasan-dong, Geumcheon-gu,
Seoul, Korea, 153-704
T +82-2-515-5303
E ups.south.korea@deltaww.com

Thailand
Delta Electronics (Thailand) Public Co.,Ltd.
909 Soi 9, Moo 4, E.P.Z., Bangpoo Industrial Estate, Tambon Phraksa,
Amphur Muang-samutprakarn, Samutprakarn Province 10280,
Thailand
T +662 709-2800
E ups.thailand@deltaww.com

Philippines
Eltek Power Inc./ Delta
302 Orient Square Bldg
F. Ortigas JR Road, Barangay
San Antonio, Pasig City
1605 Philippines
E ups.philippines@deltaww.com

Australia
Delta Electronics (Australia) Pty Ltd.
St Leonard's Corporate Centre
Unit 18/39 Herbert Street, St Leonards NSW 2065, Australia
T +61 2 9479 4200
E ups.australia@deltaww.com

UK
Delta Electronics (UK) Ltd.
Eltek House, Unit 1 Cleveland Road, Hemel Hempstead,
Hertfordshire, HP2 7EY, UK
T +44 1442 210805
E sales.gb@eltek.com

U.S.A
Delta Electronics (Americas) Ltd.
46101 Fremont Blvd. Fremont, CA 94538
T +1 510 668 5100
E ups.na@deltaww.com

Colombia
Delta Electronics Colombia SAS
Cra 72 # 95 – 51 Bodega 16, Parque Empresarial Los Lagartos
Bogota DC, Colombia
T +57 317 4052794
E ups.colombia@deltaww.com

India
Delta Electronics India Pvt. Ltd.
Plot No. 43, Sector-35, HSIDC, Gurgaon-122001,
Haryana, India
T +91 124 4874 900
E ups.india@deltaww.com

Japan
Delta Electronics (Japan), Inc.
2-1-14 Shibadaimon, Minato-Ku, Tokyo, 105-0012,
Japan
T +81-3-5733-1111
E jpstps@deltaww.com

Singapore
Delta Electronics Int'l (Singapore) Pte Ltd.
17 Kallang Junction, #01-01, TRION,
Singapore 339274
T +65 6747 5155
E ups.singapore@deltaww.com

Vietnam
Delta Electronics (Vietnam) Co., Ltd.
6th floor Gems Empire Tower, No. 201 Truong Chinh
street, Phuong Liet Ward, Ha Noi City, Vietnam
T +84 974 766 198
E ups.vietnam@deltaww.com

Indonesia
Delta Electronics International (S) Pte Ltd.
Soho Capital, 30th Fl, Unit SC3009
Jl. Letjend S. Parman kav 28. Jakarta 11470 Indonesia
T + 65 9667 4687
E ups.indonesia@deltaww.com

